

Center Console Area

How to use this manual.

1  
Center Console Assembly Removal

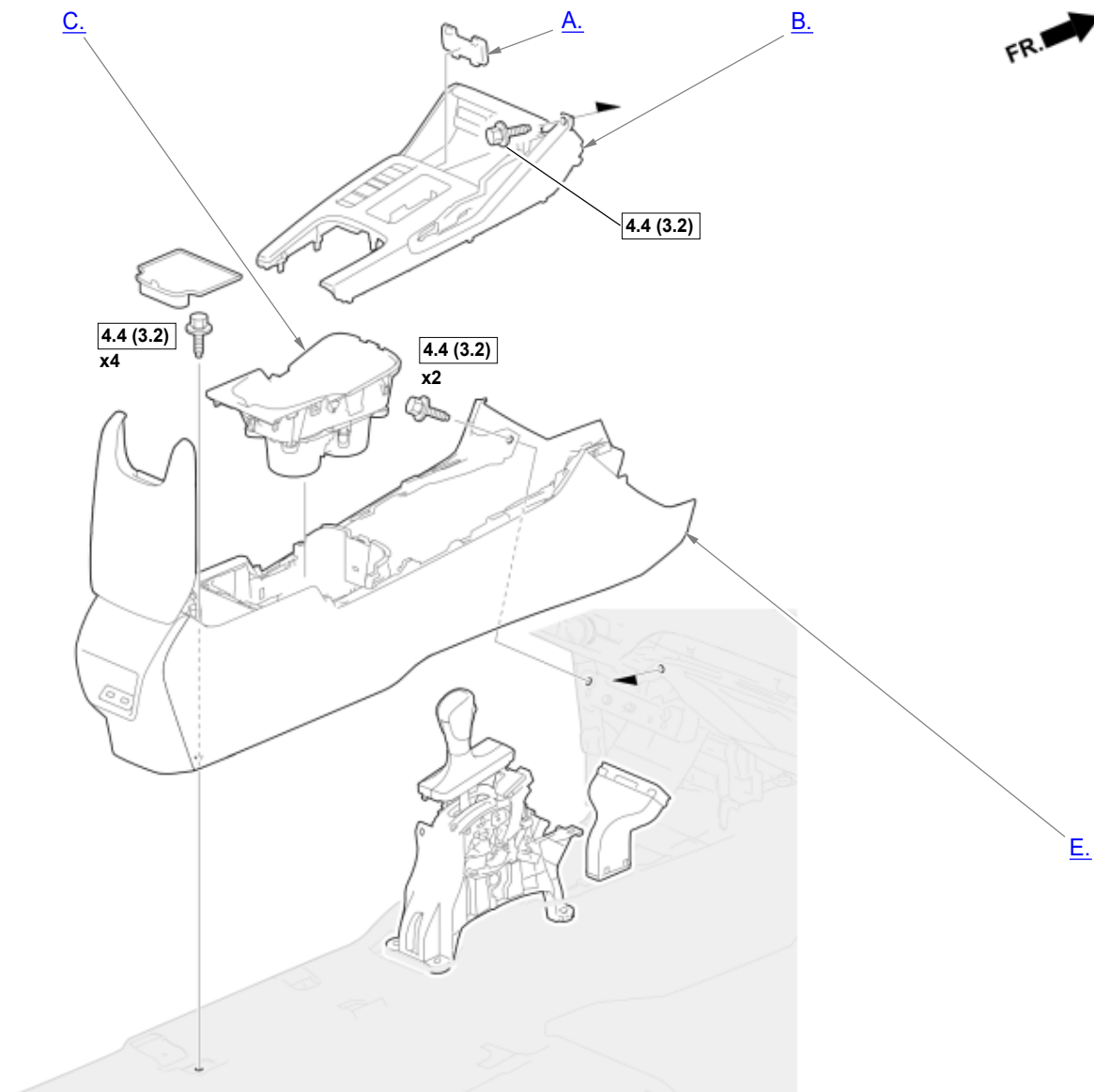
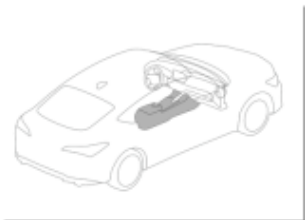

  
Change

3  
Bookmarks

  
Library

  
Convert

  
Reference - Repair

2

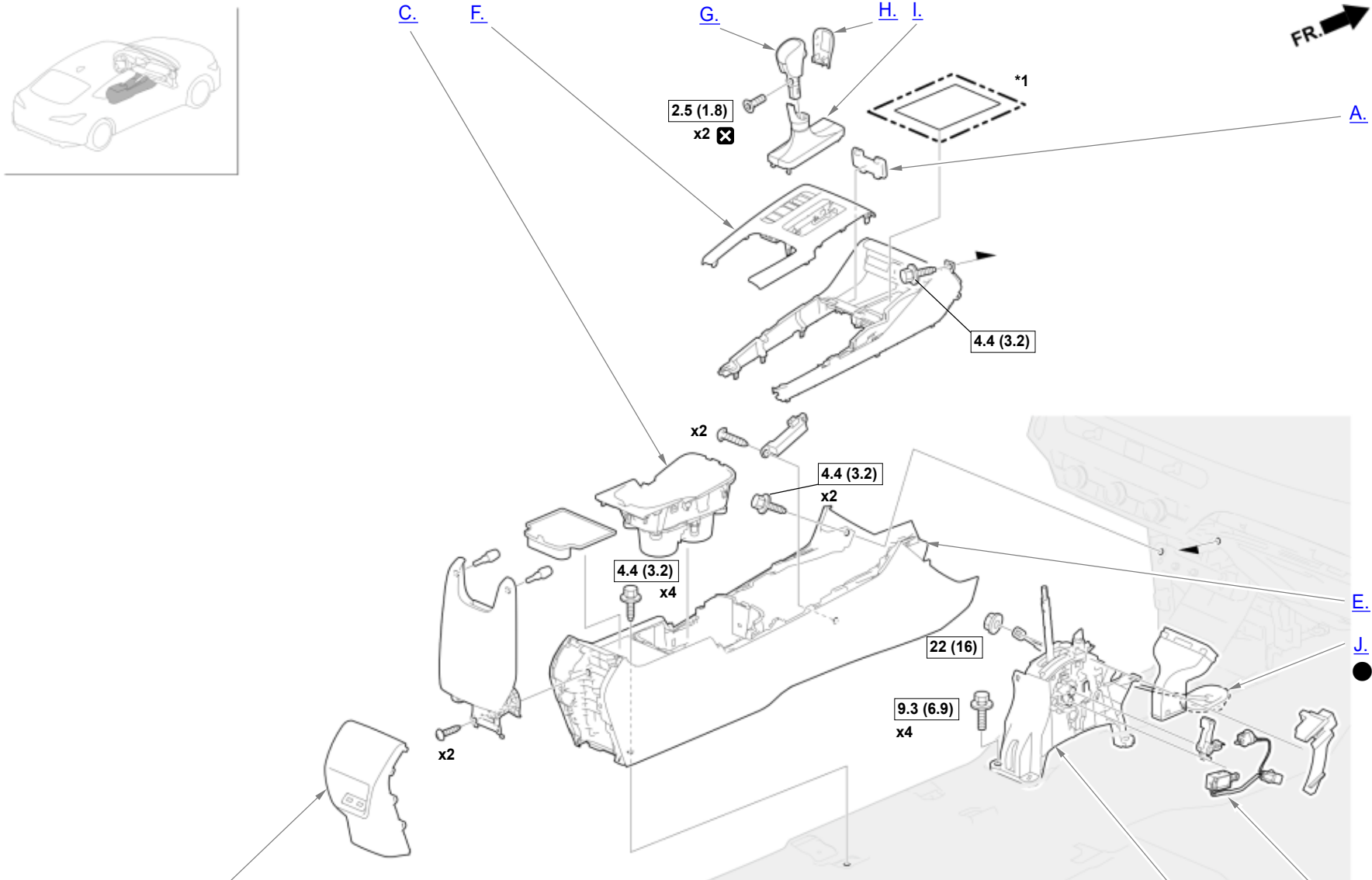

<div><div></div> : Torque, N·m (lbf·ft)</div>	<div><div>✕</div> : Replace</div>	<div><div>⚠</div> : Warning/Caution</div>	<div><div>●</div> : Inspection/Adjustment</div>	<div><div>★</div> : Learning</div>	<div><div>■</div> : SPL Tool</div>	<div><div>←</div> : Required Removal</div>
---	---------------------------------------	---	---	------------------------------------	------------------------------------	--

\*1: Without wireless charger

3

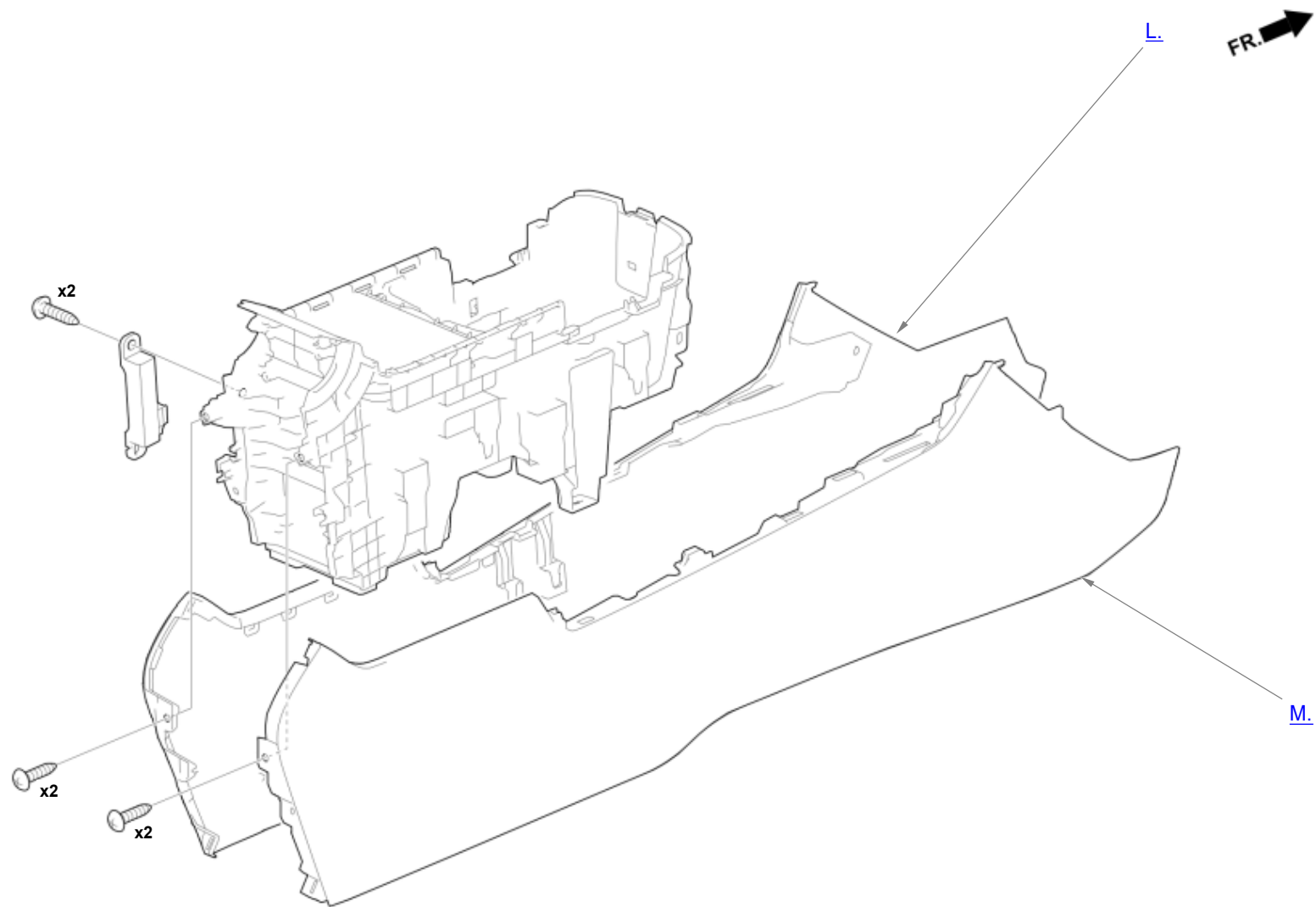

4

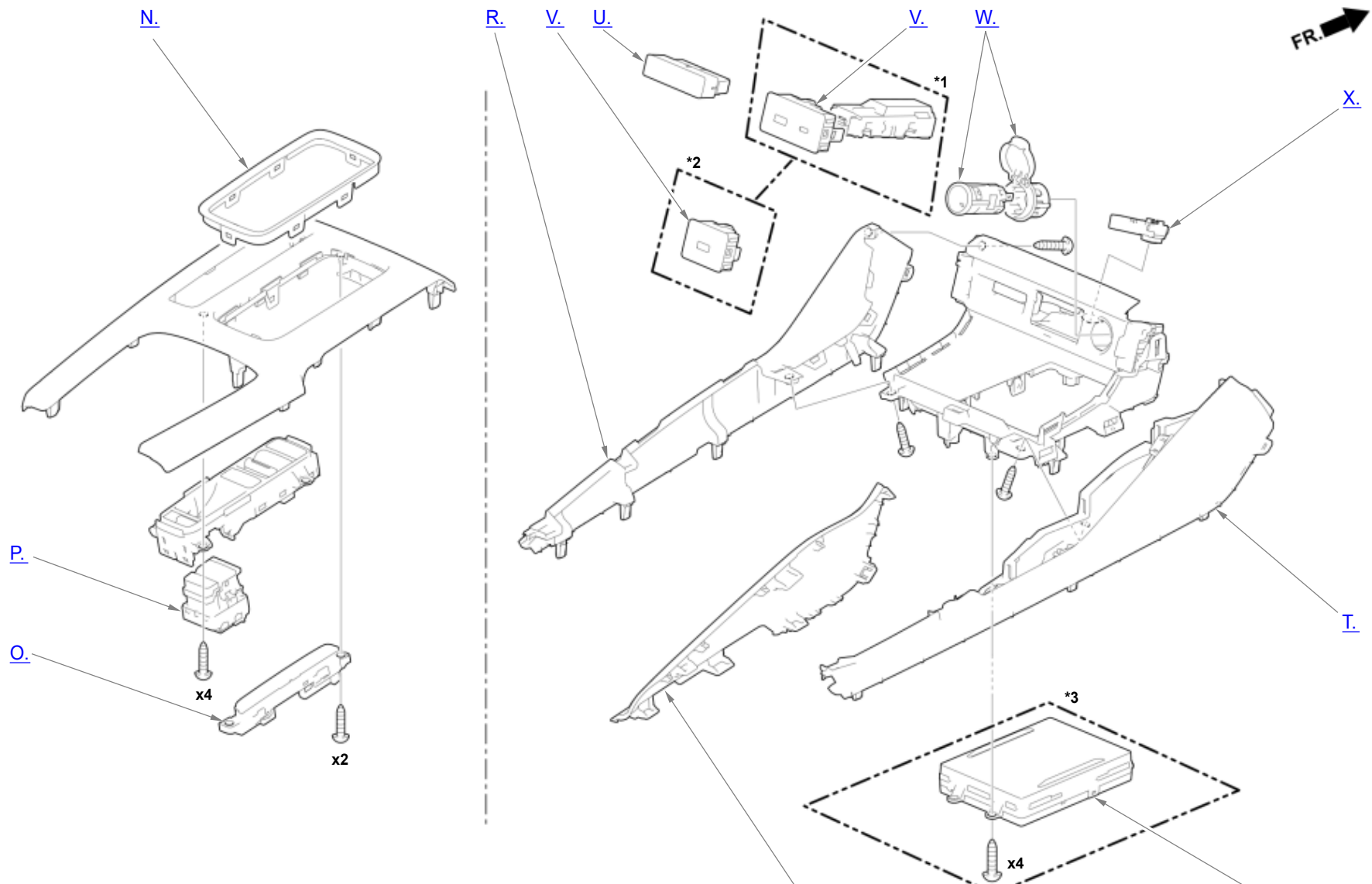

  
Change

3  
Bookmarks

  
Library

  
Convert

  
Reference - Repair

<div> <div></div> <div>: Torque, N·m</div> </div> <div>(lbf·ft)</div>	<div> <div>✕</div> <div>:</div> </div> <div>Replace</div>	<div> <div>⚠</div> <div>:</div> </div> <div>Warning/Caution</div>	<div> <div>●</div> <div>:</div> </div> <div>Inspection/Adjustment</div>	<div>★: Learning</div>	<div>■: SPL Tool</div>	<div> <div>←</div> <div>: Required Removal</div> </div>
---	---	---	---	------------------------	------------------------	---

\*1: Display audio type (9-inch screen)

\*2: Color audio type (7-inch screen)

\*3: With wireless charger

5

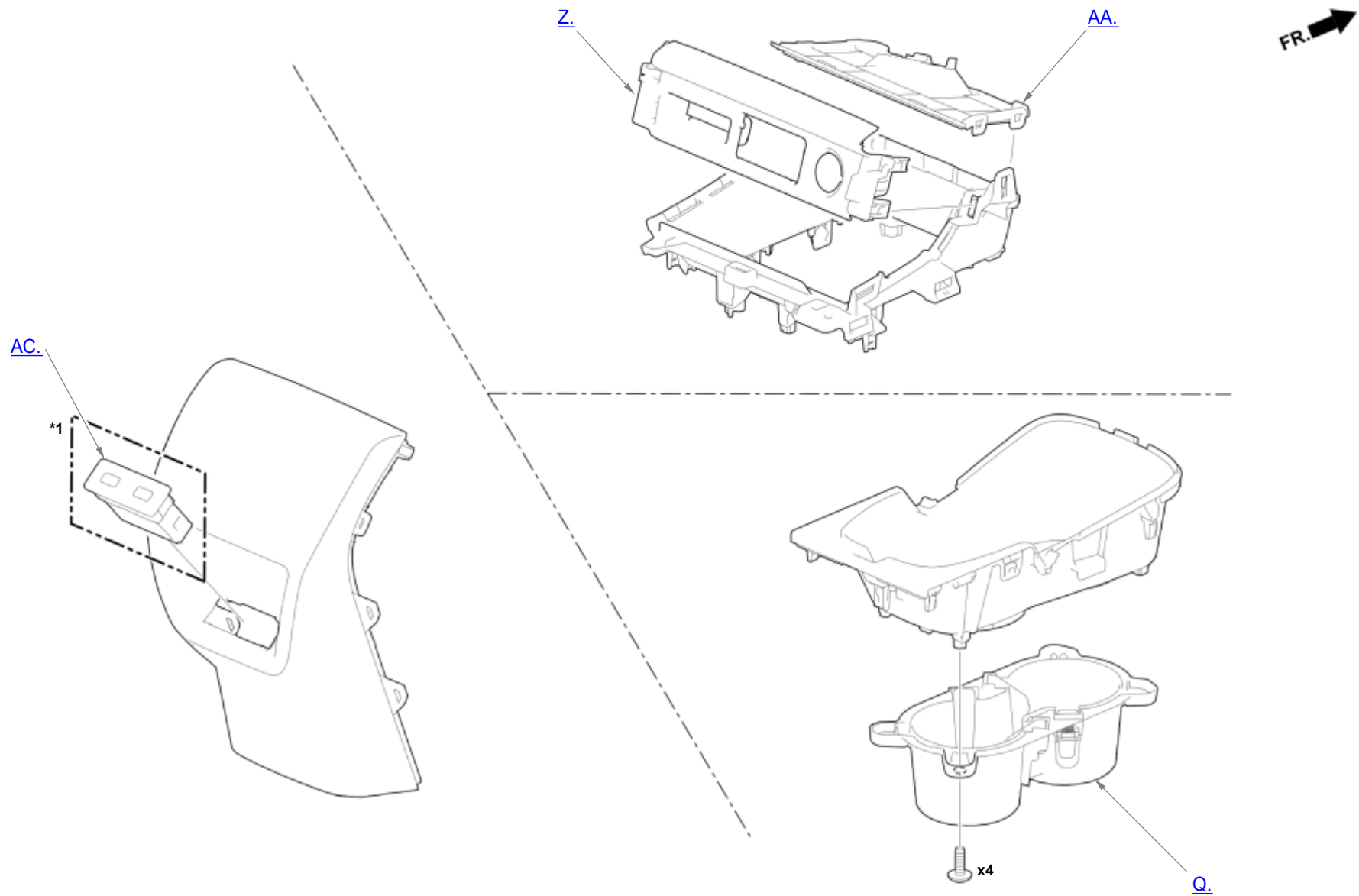

\*1: Display audio type (9-inch screen)

A. -

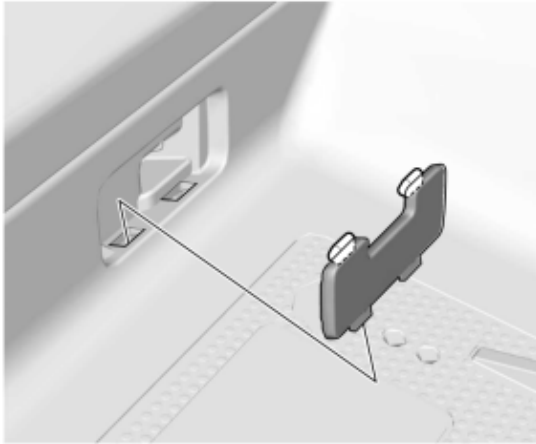

B. -

## ■ Key Information

Do the following before starting your work.

### Remove:

- Passenger's Pad Assembly

## ● Removal

- Refer to the figure.

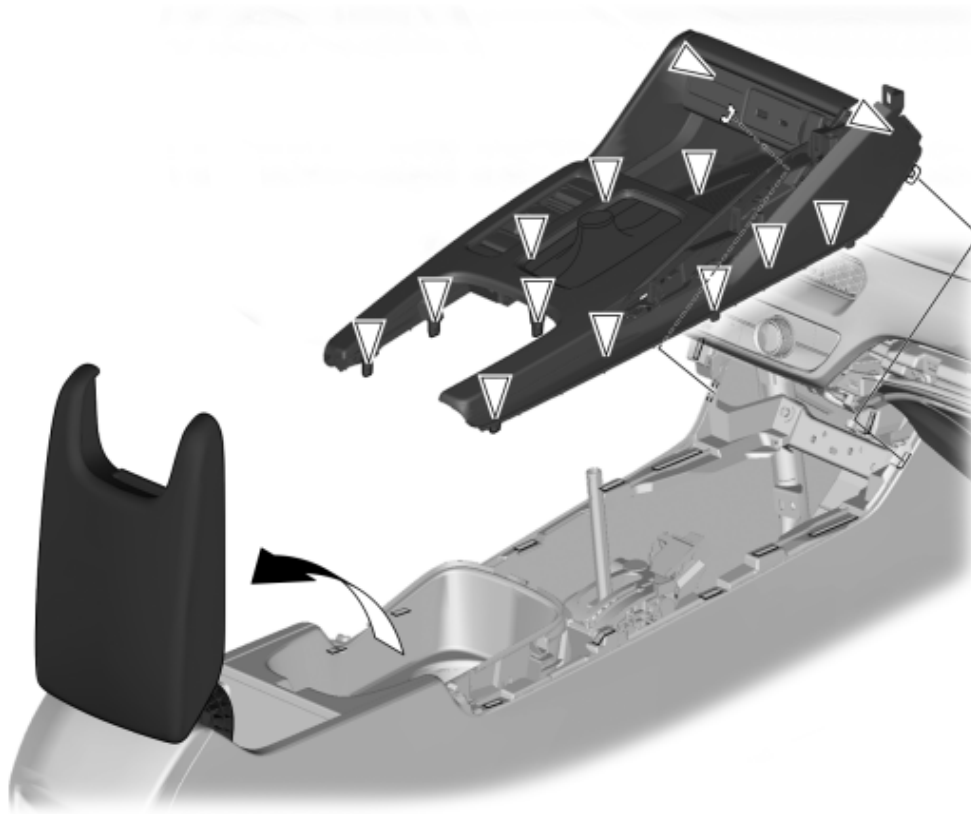

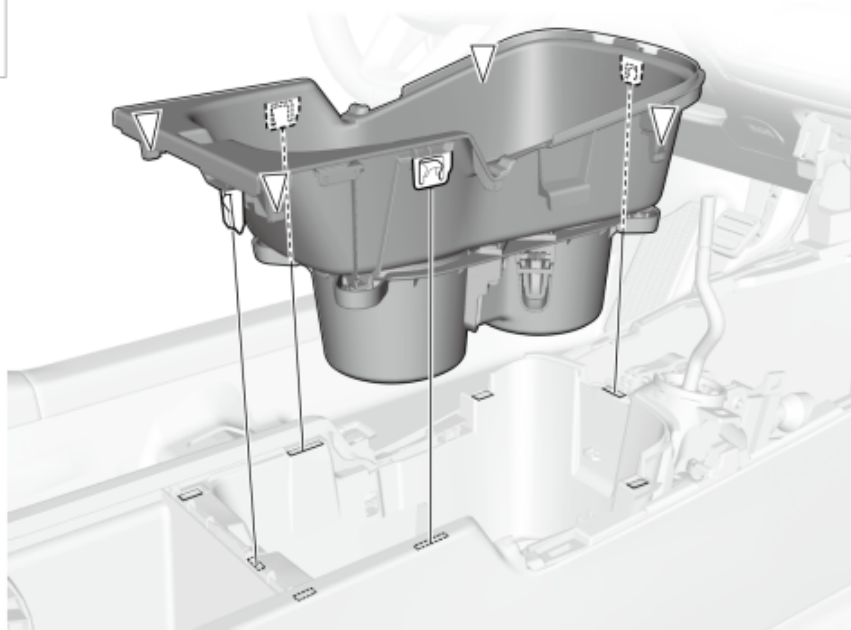
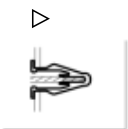

D. -

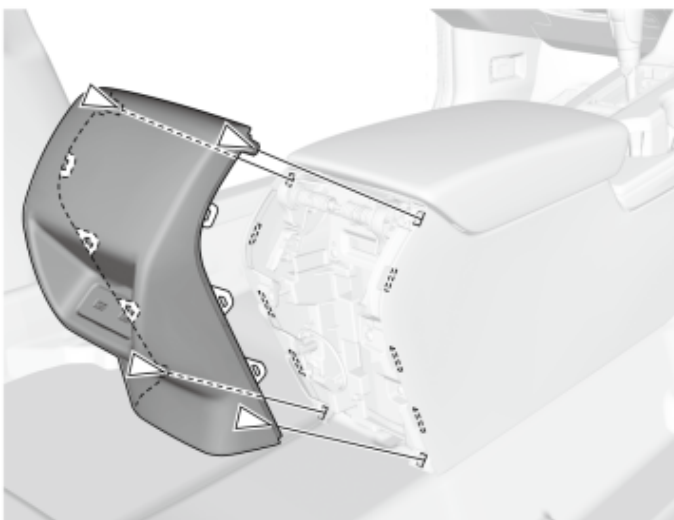
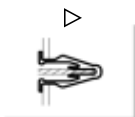

E. -

## ■ Sub-Procedure

### ● Removal

- Refer to the figure.

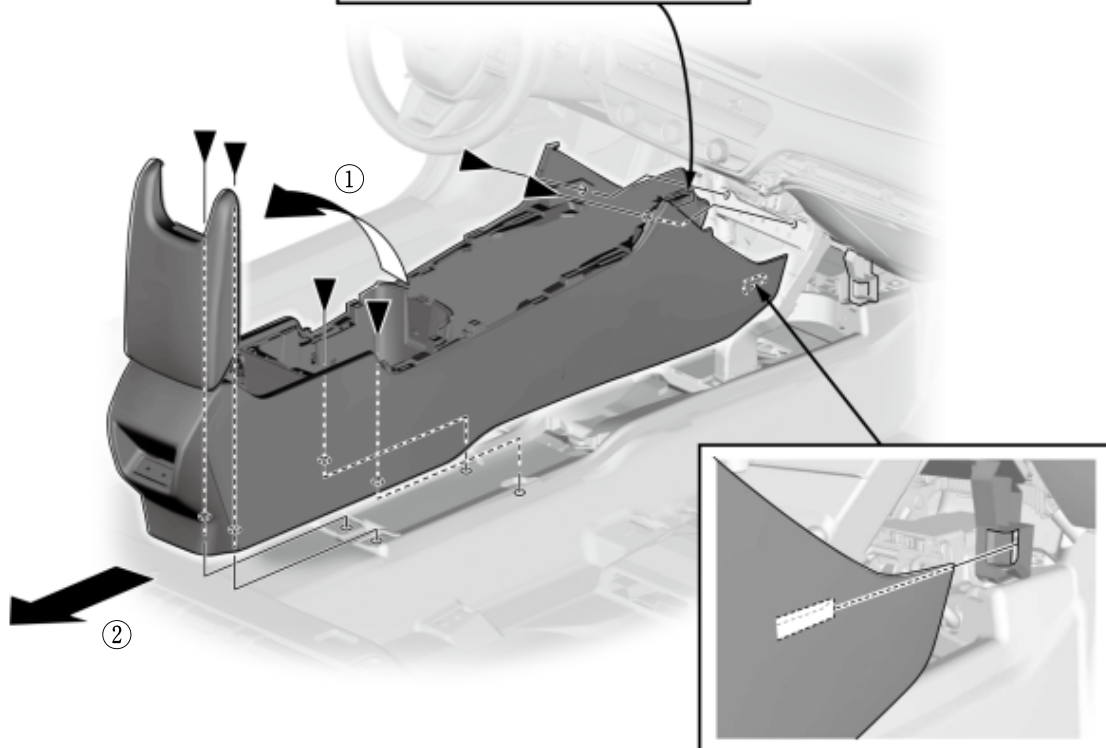
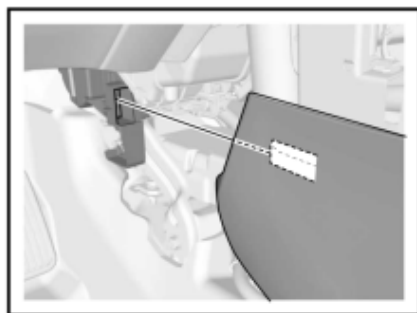
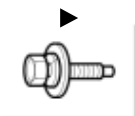

F. -

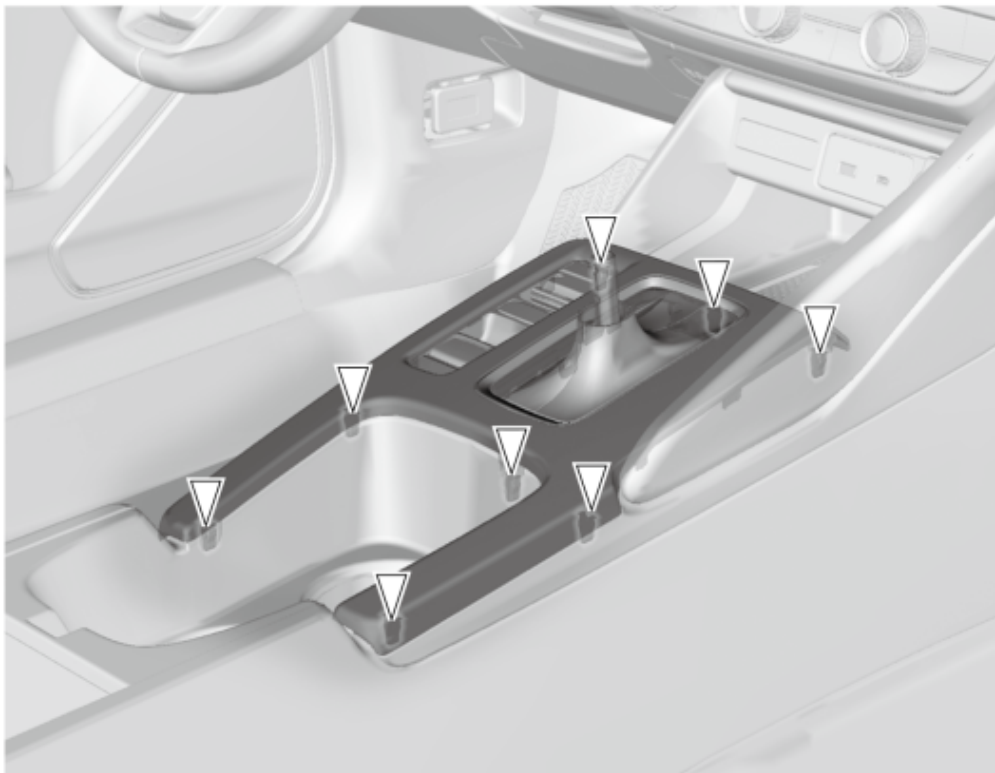
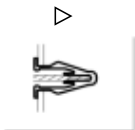

G. -

## ■ Sub-Procedure



Change

3

Bookmarks



Library



Convert



Reference - Repair

## NOTICE

Do not wipe off the special grease.

- Refer to the figure.

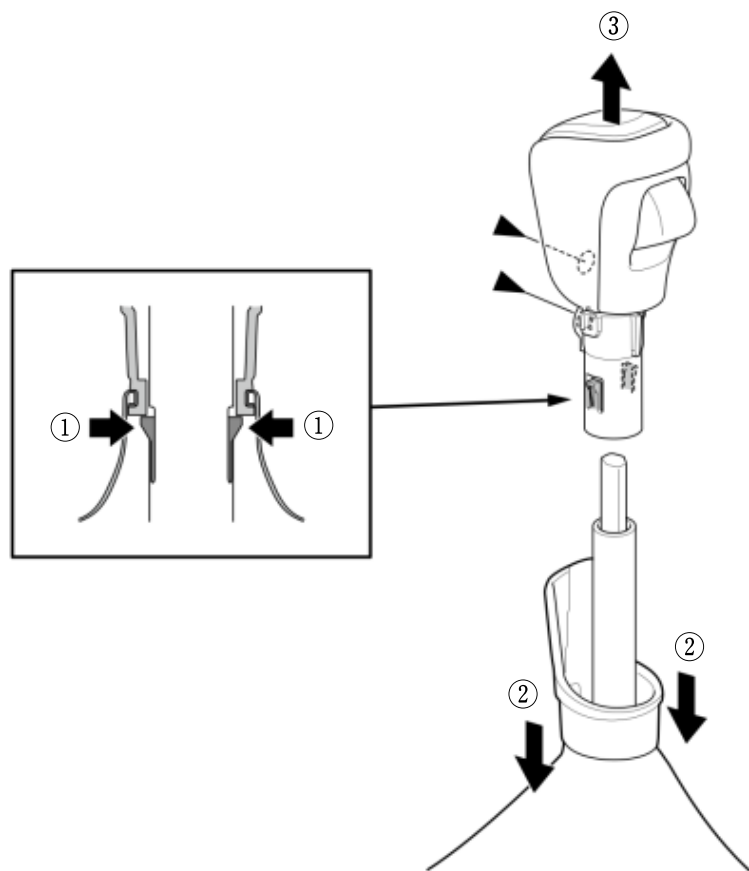

## ■ Sub-Procedure

### ● Removal

- Refer to the figure.

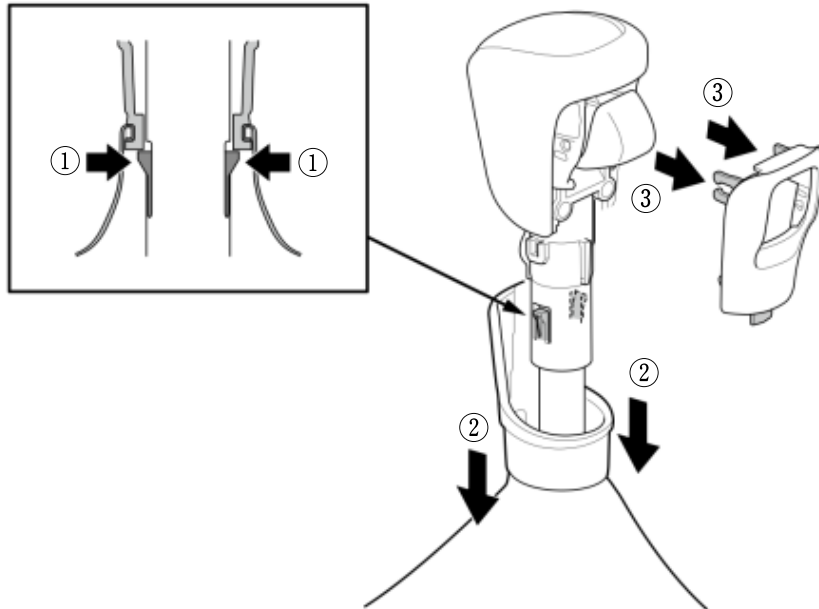

I. -

## ■ Sub-Procedure



Change

3

Bookmarks



Library



Convert



Reference - Repair

## ● Removal

- Refer to the figure.

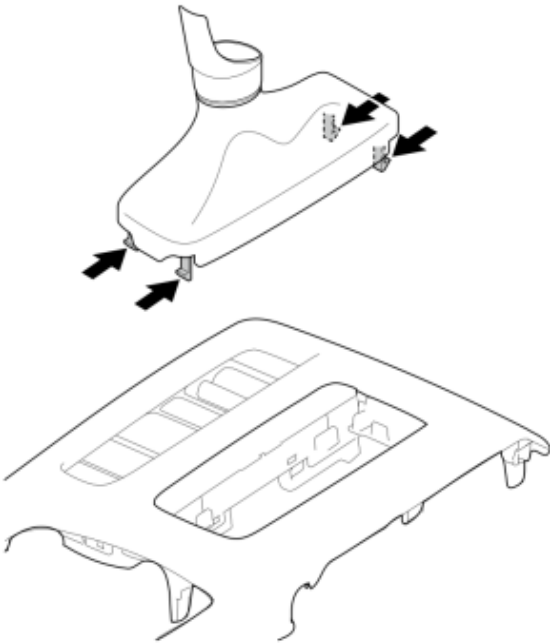

J. -

## ■ Preconditions

- Transmission R position/mode

## ■ Sub-Procedure

**NOTICE**

- Do not remove the shift cable by pulling the shift cable guide (a). (Figure 1)

Figure 1

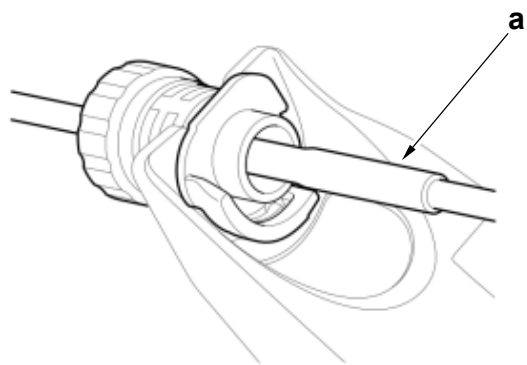

• Removal

1. Refer to figure 2.

Pin Specifications (Figure 2)

Specification	
b	6.0 mm (0.24 in)

Figure 2

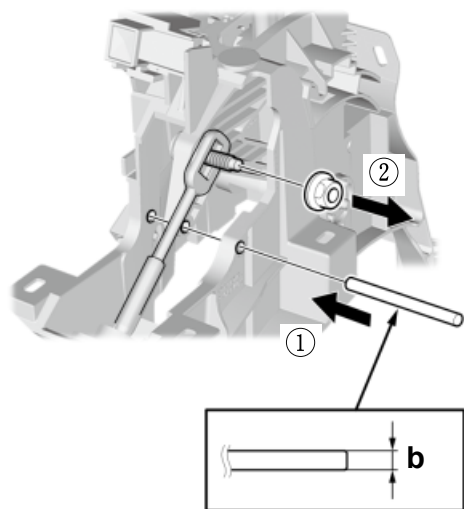

2. Refer to figure 3.

Figure 3

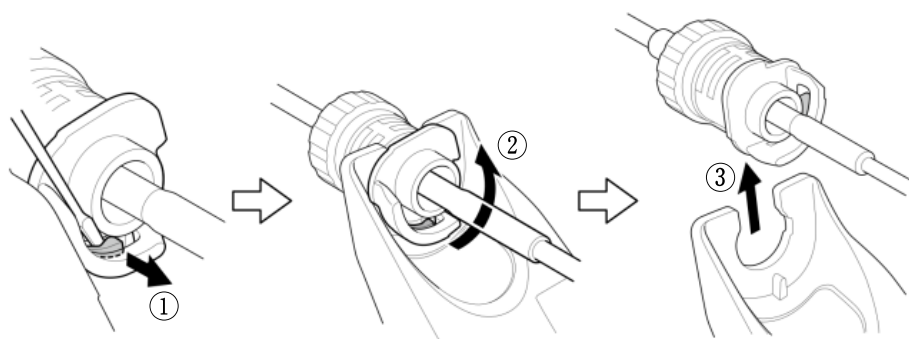

2. Refer to figure 4.

**Figure 4**

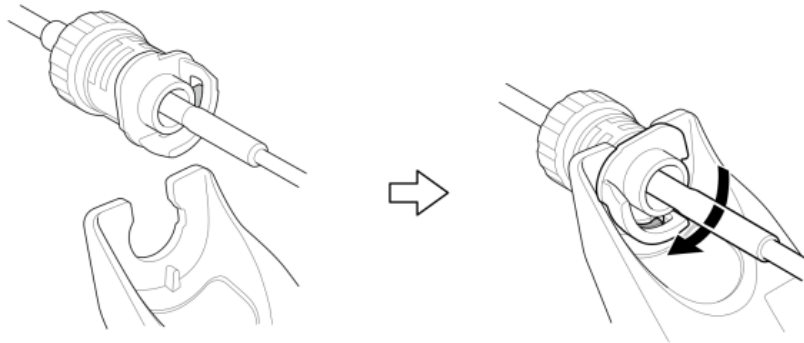

3. Make sure that the shift cable end (a) is properly installed on the mounting stud (b). (Figure 5)

**Figure 5**

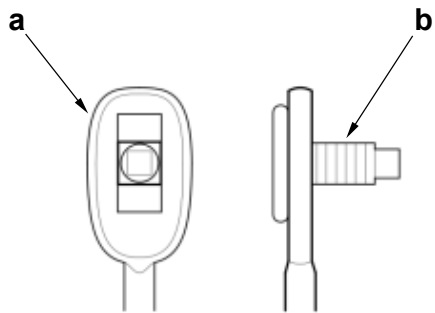

- Shift cable after install check.
    - 1. Turn the vehicle to the ON mode.
    - 2. Move the shift lever to each position/mode, and check that the shift position indicator follows the shift lever operation.
    - 3. Shift the transmission to P position/mode, and check that the shift lock works properly.
    - 4. Push the shift lock release, and check that the shift lever releases. Also check that the shift lever locks when it is shifted back to P position/mode.
    - 5. Start the engine.
- NOTE: Check that the engine starts in P or N position/mode, and does not start in any other positions/modes.
- 6. Make sure the vehicle is turned to the OFF (LOCK) mode with the shift lever in P position/mode. If it is not, adjust the shift cable again.

K. -

## ■ Sub-Procedure

### ● Removal

#### NOTICE

Do not wipe off the special grease.

L. -



Change

3

Bookmarks



Library



Convert



Reference - Repair

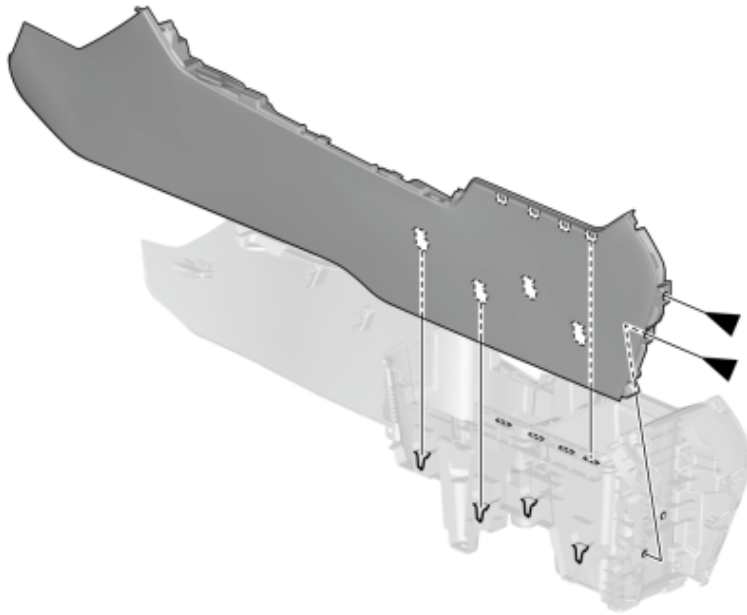
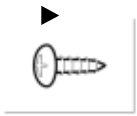

M.-



3  
Bookmarks

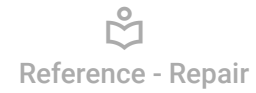

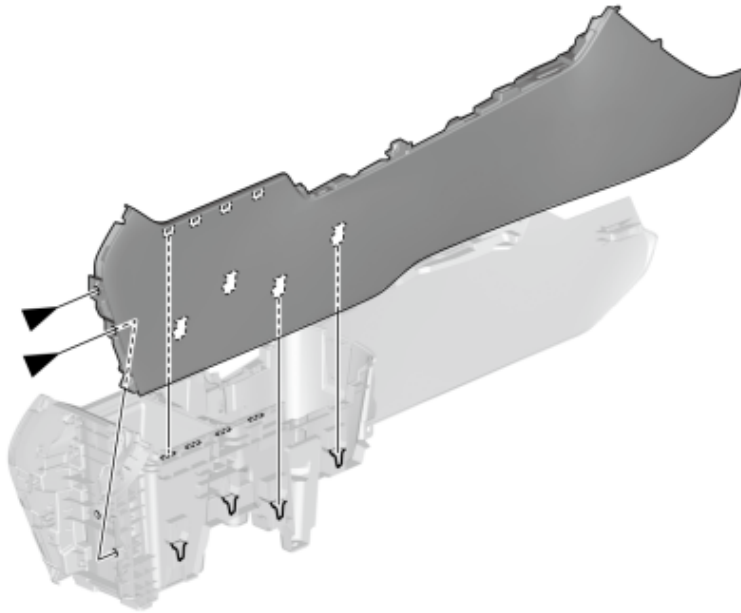
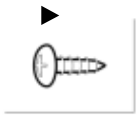

N. -

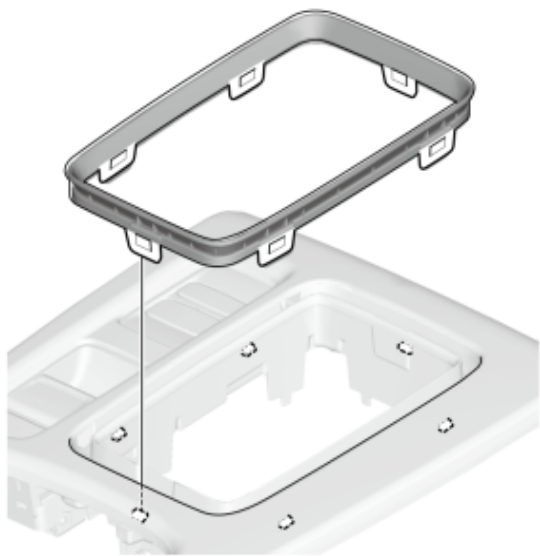

0. -

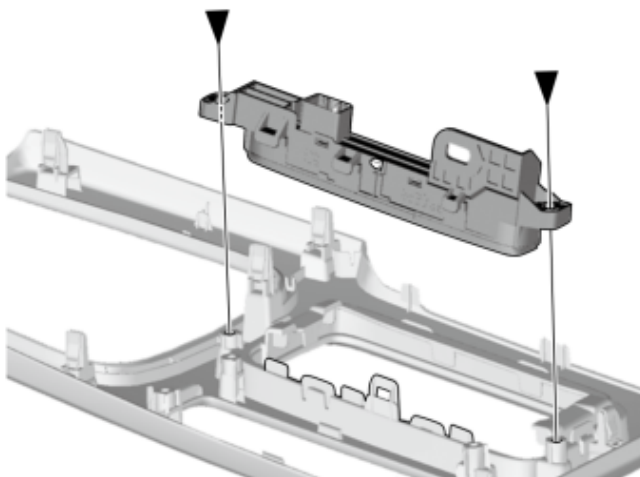
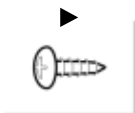

P. -

  
Change

3  
Bookmarks

  
Library

  
Convert

  
Reference - Repair

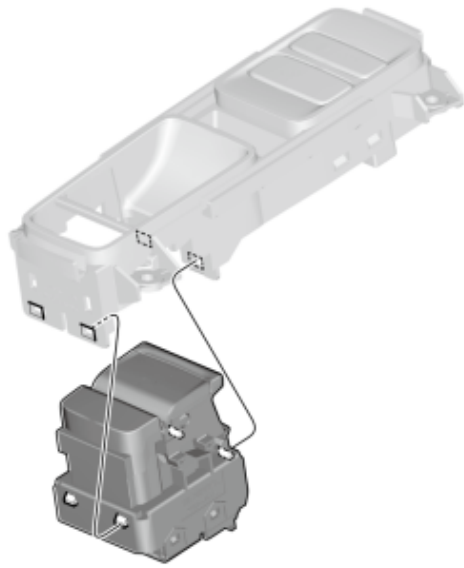

Q. -



Change

3

Bookmarks



Library



Convert



Reference - Repair

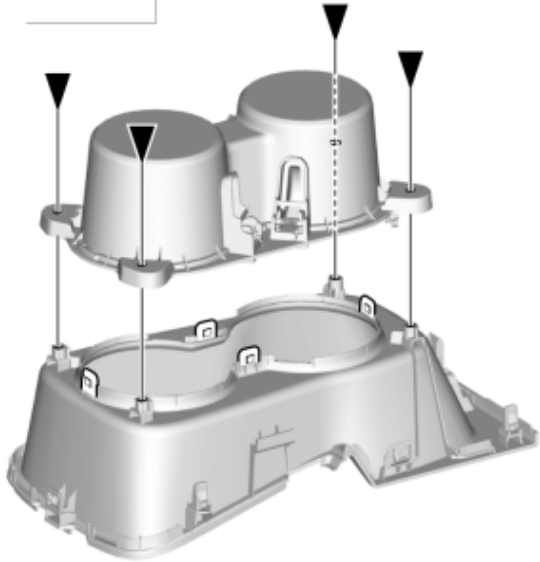
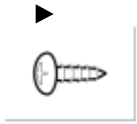

R. -

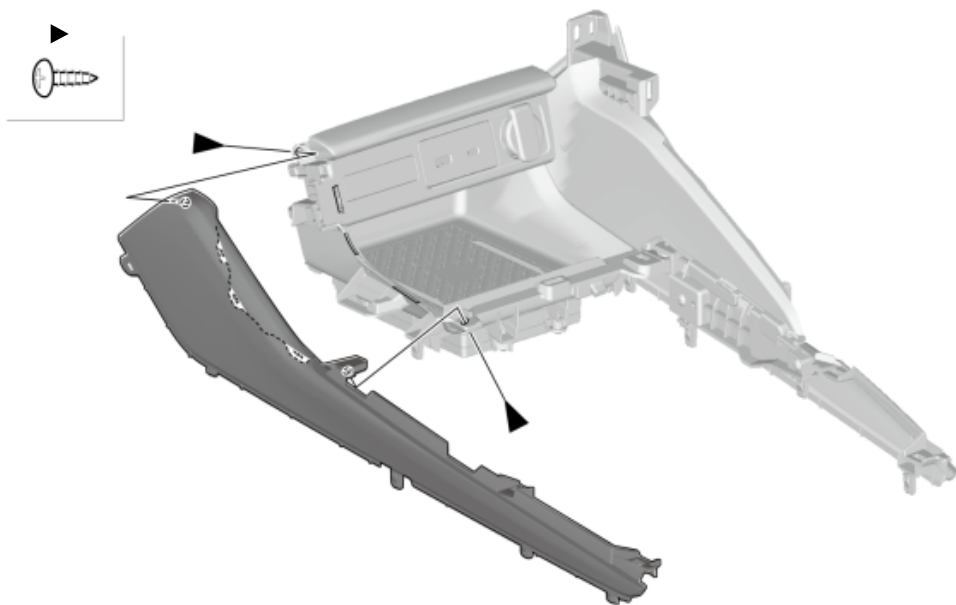

S. -

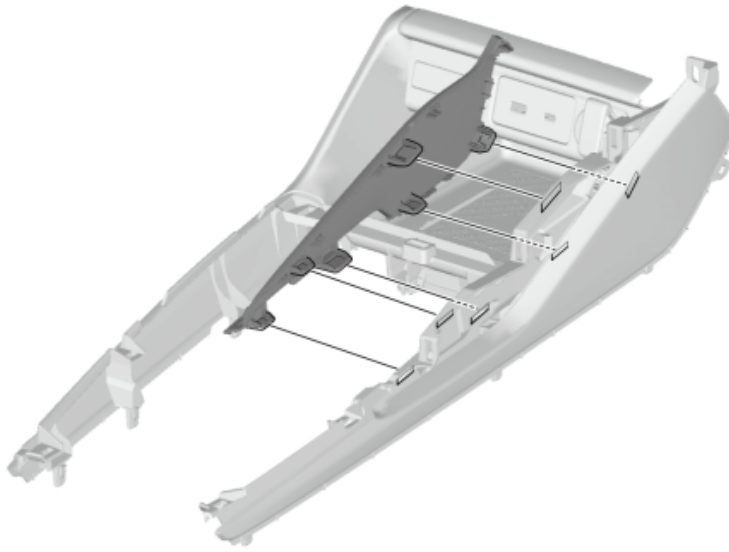

T. -



Change

3

Bookmarks



Library



Convert



Reference - Repair

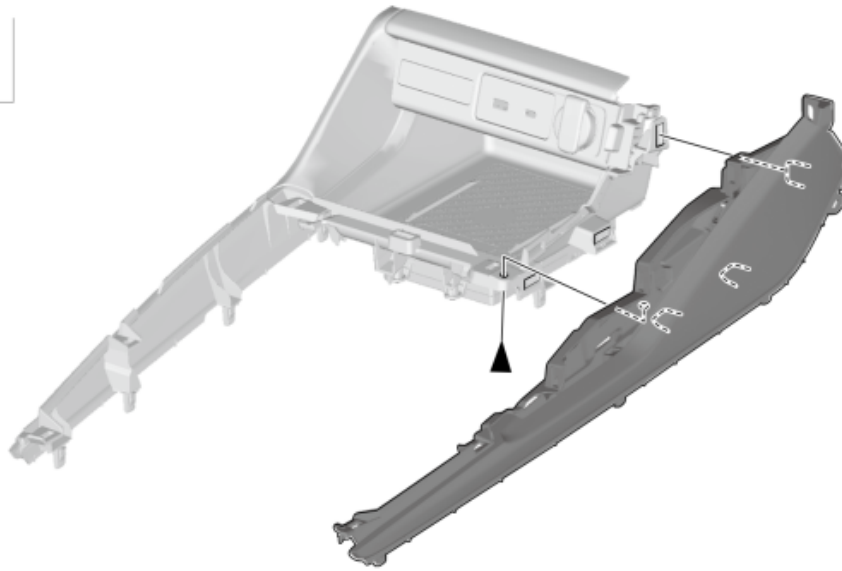
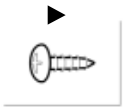

U. -

## ■ Sub-Procedure

  
Change

3  
Bookmarks

  
Library

  
Convert

  
Reference - Repair

## ● Removal

- Refer to the figure.

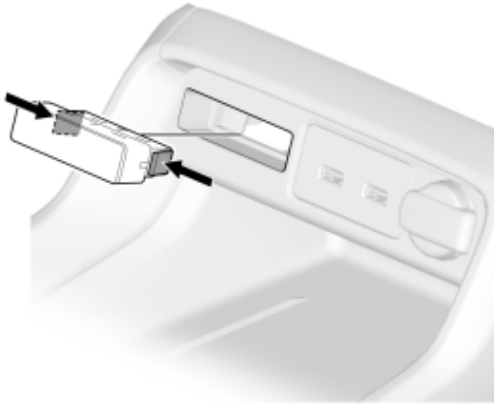

V. -

## ■ Sub-Procedure

## ● Removal

- Refer to the figure.

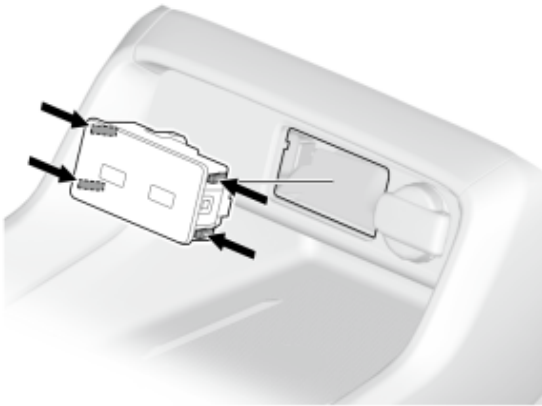

W.-

## ■ Sub-Procedure

## ● Removal

- Refer to the figure.



Change

3

Bookmarks



Library



Convert



Reference - Repair

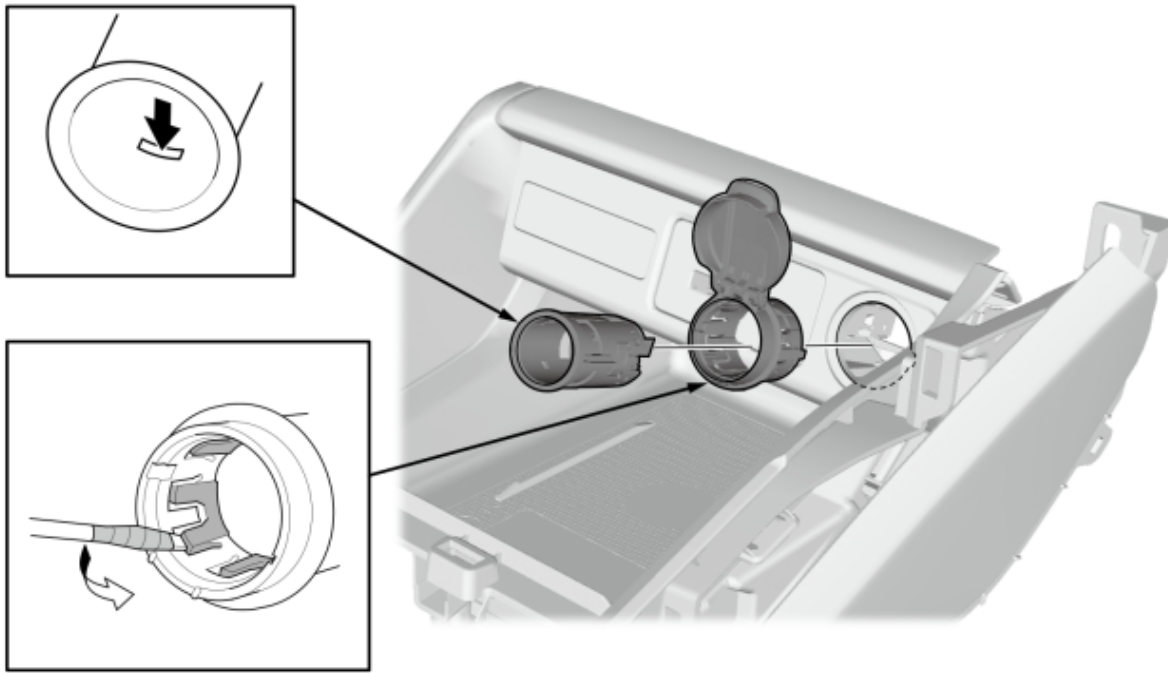

X. -

## ■ Sub-Procedure

  
Change

3  
Bookmarks

  
Library

  
Convert

  
Reference - Repair

## ● Removal

- Refer to the figure.

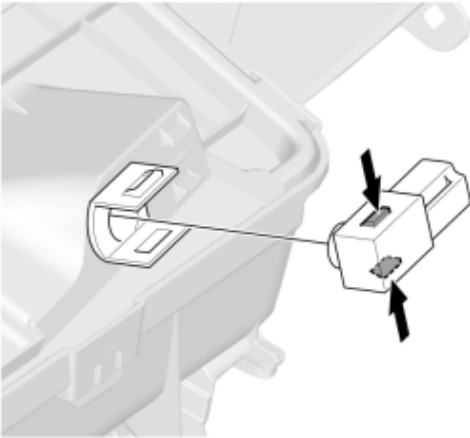

Y. -

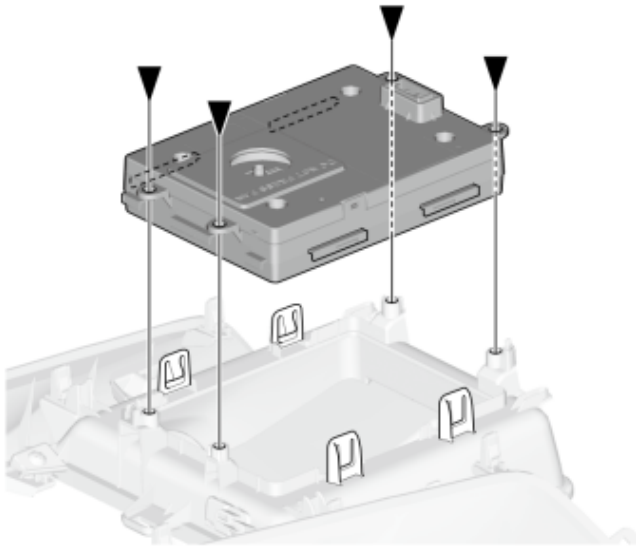
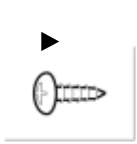

Z. -

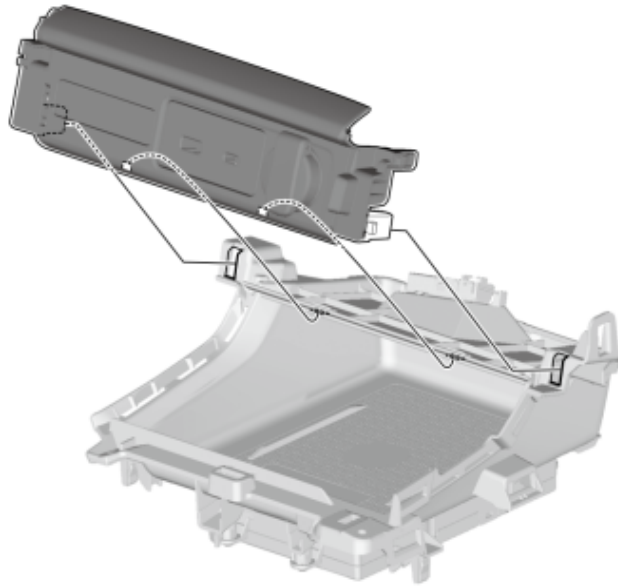

AA.-

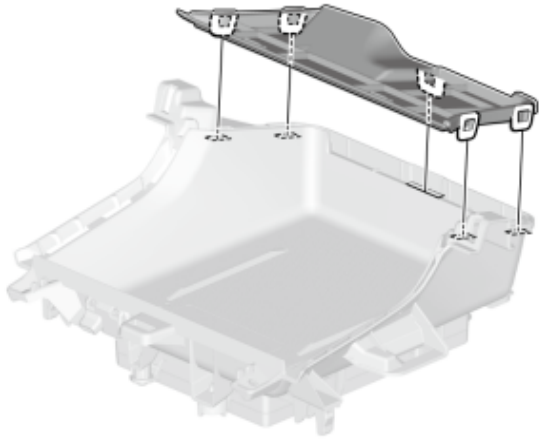

AB.-

## ■ Sub-Procedure



Change

3

Bookmarks



Library



Convert



Reference - Repair

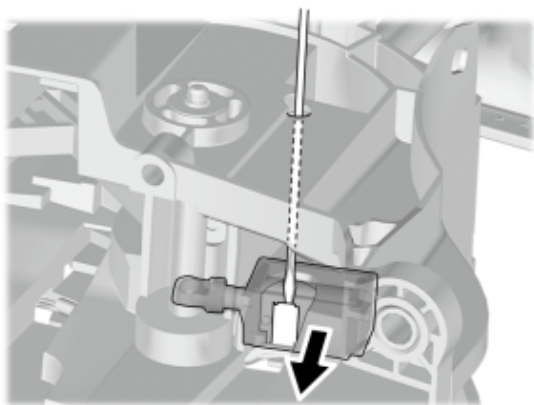

## ● Removal

### NOTICE

Do not wipe off the special grease.

- Refer to the figure.

AC.-

## ■ Sub-Procedure

## • Removal

- Refer to the figure.

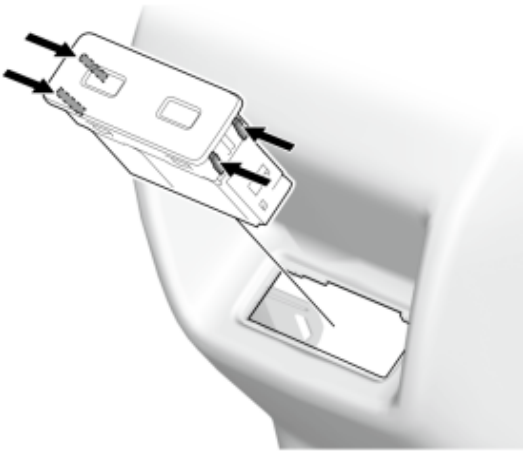

1

Center Console Assembly Removal



Change

3

Bookmarks



Library



Convert



Reference - Repair

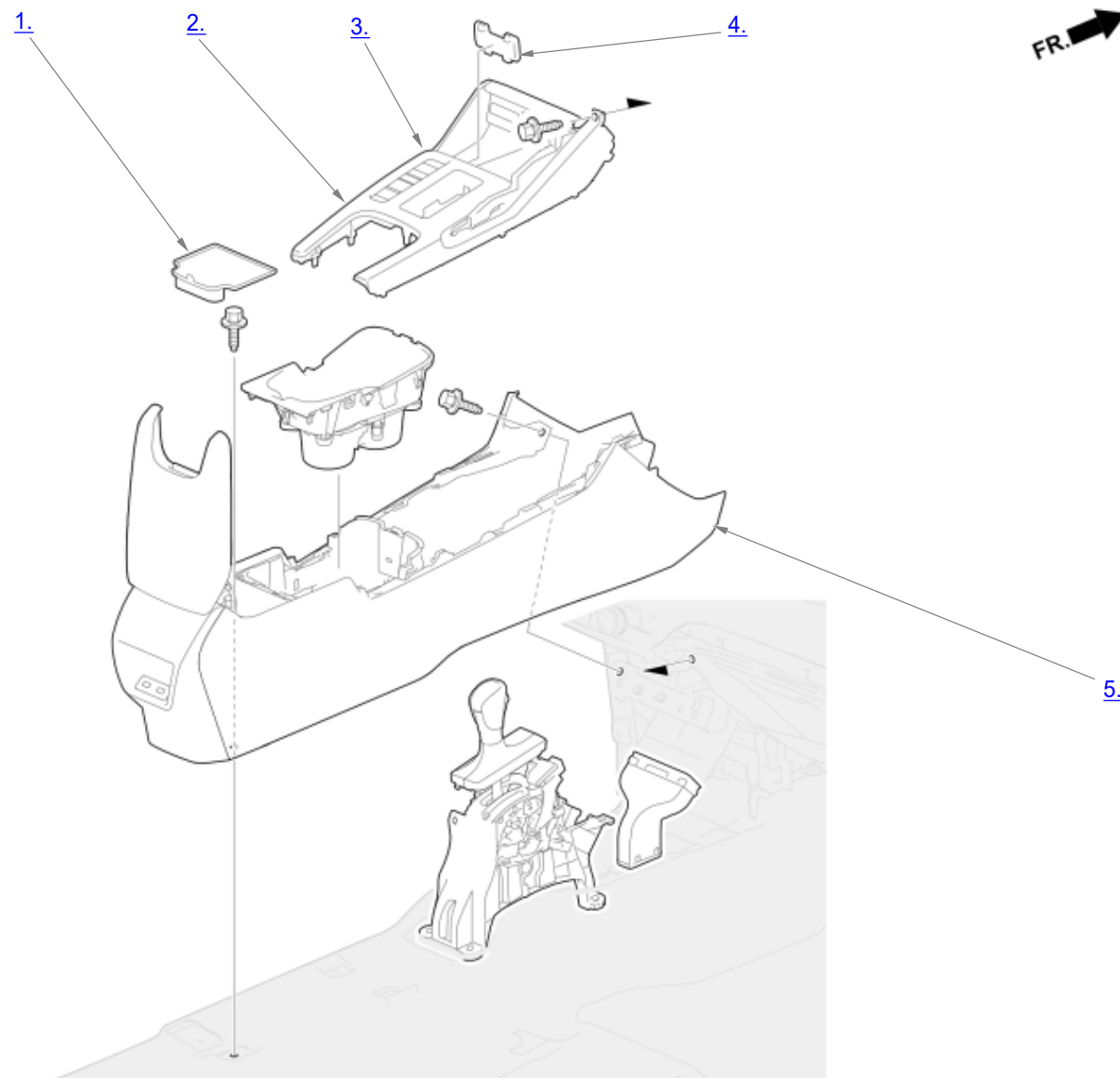
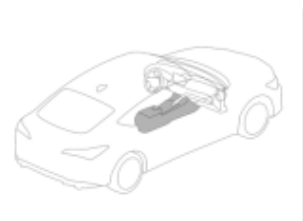

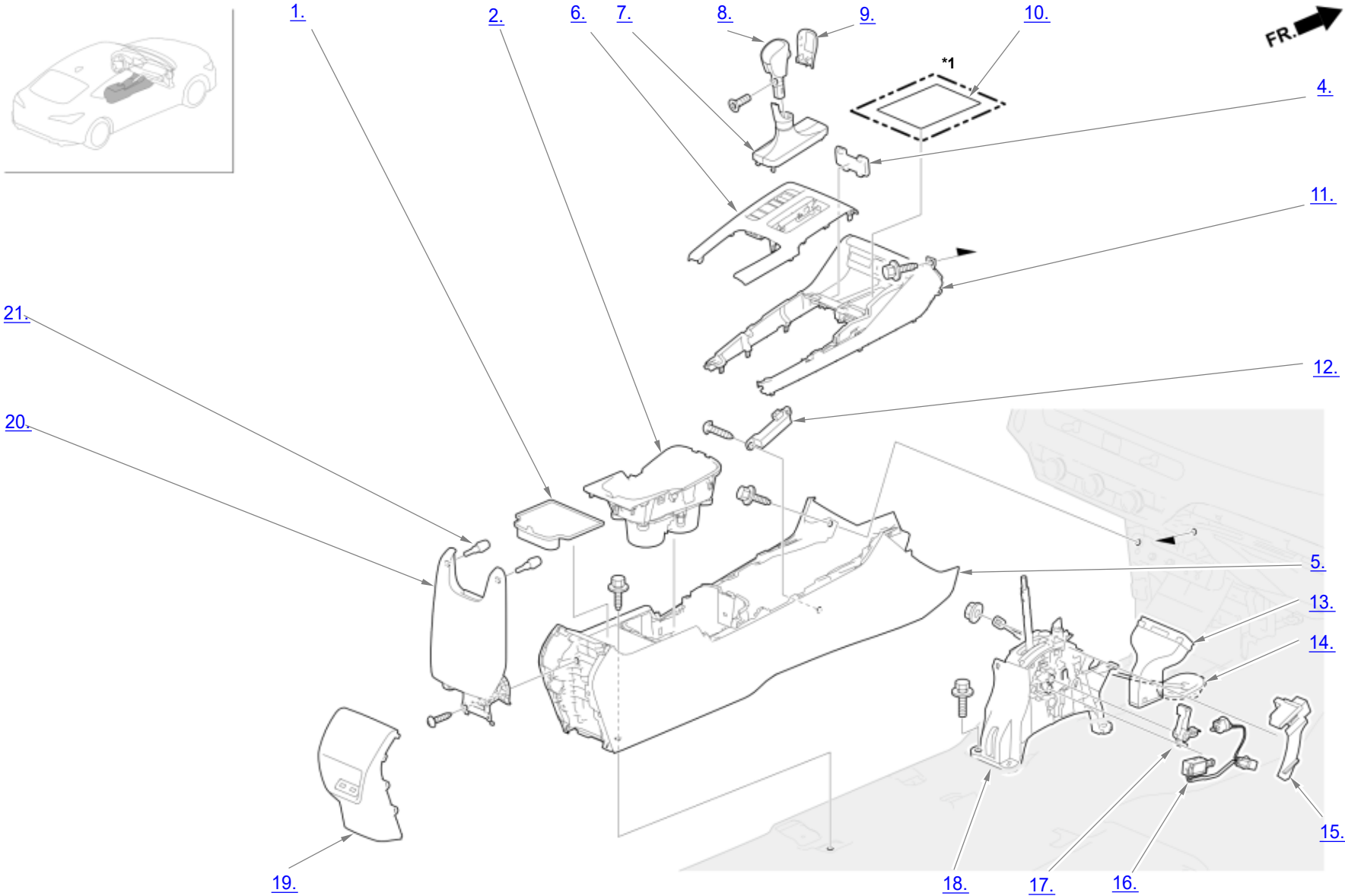

\*1: Without wireless charger

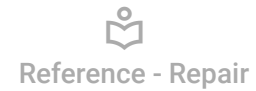

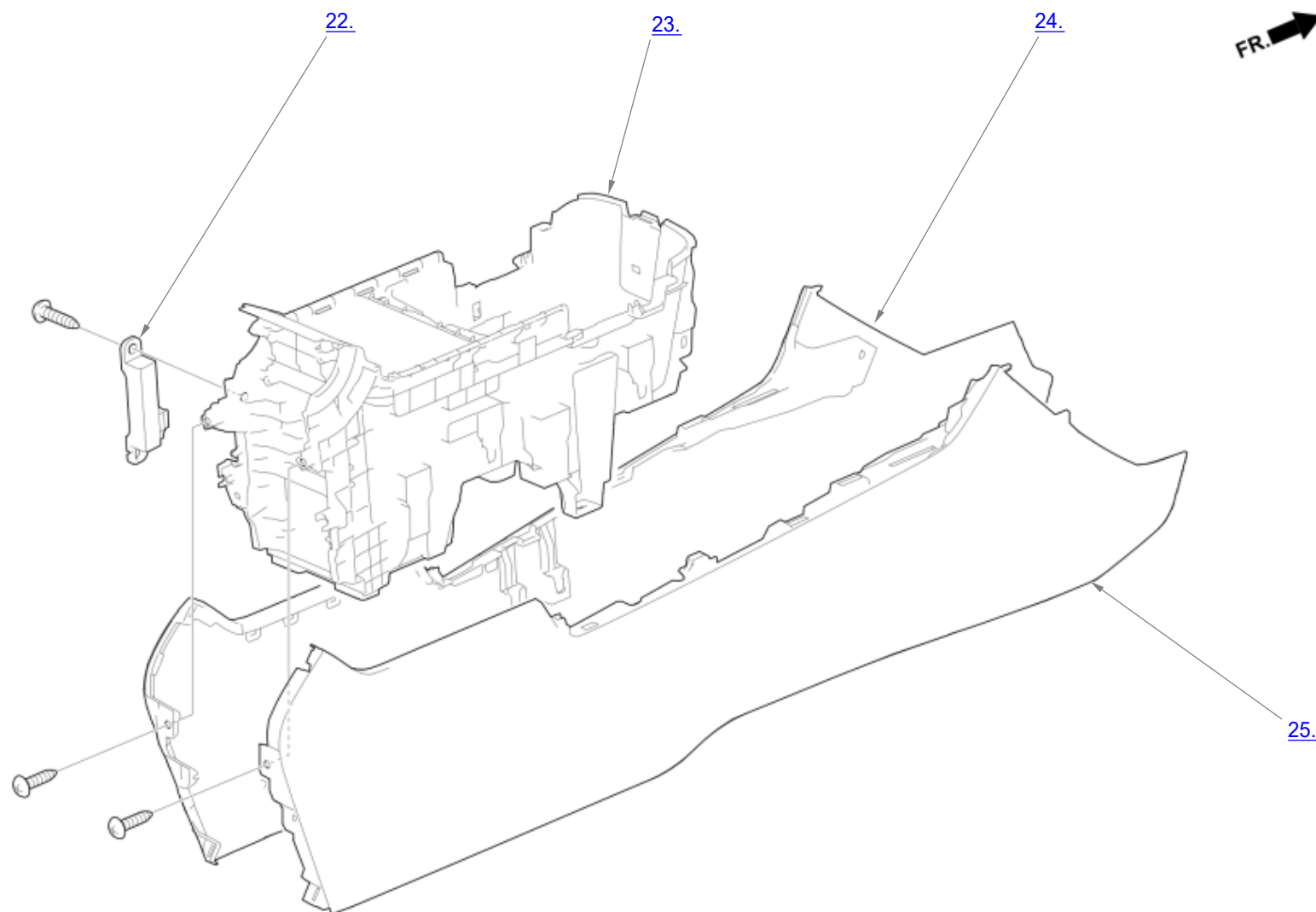

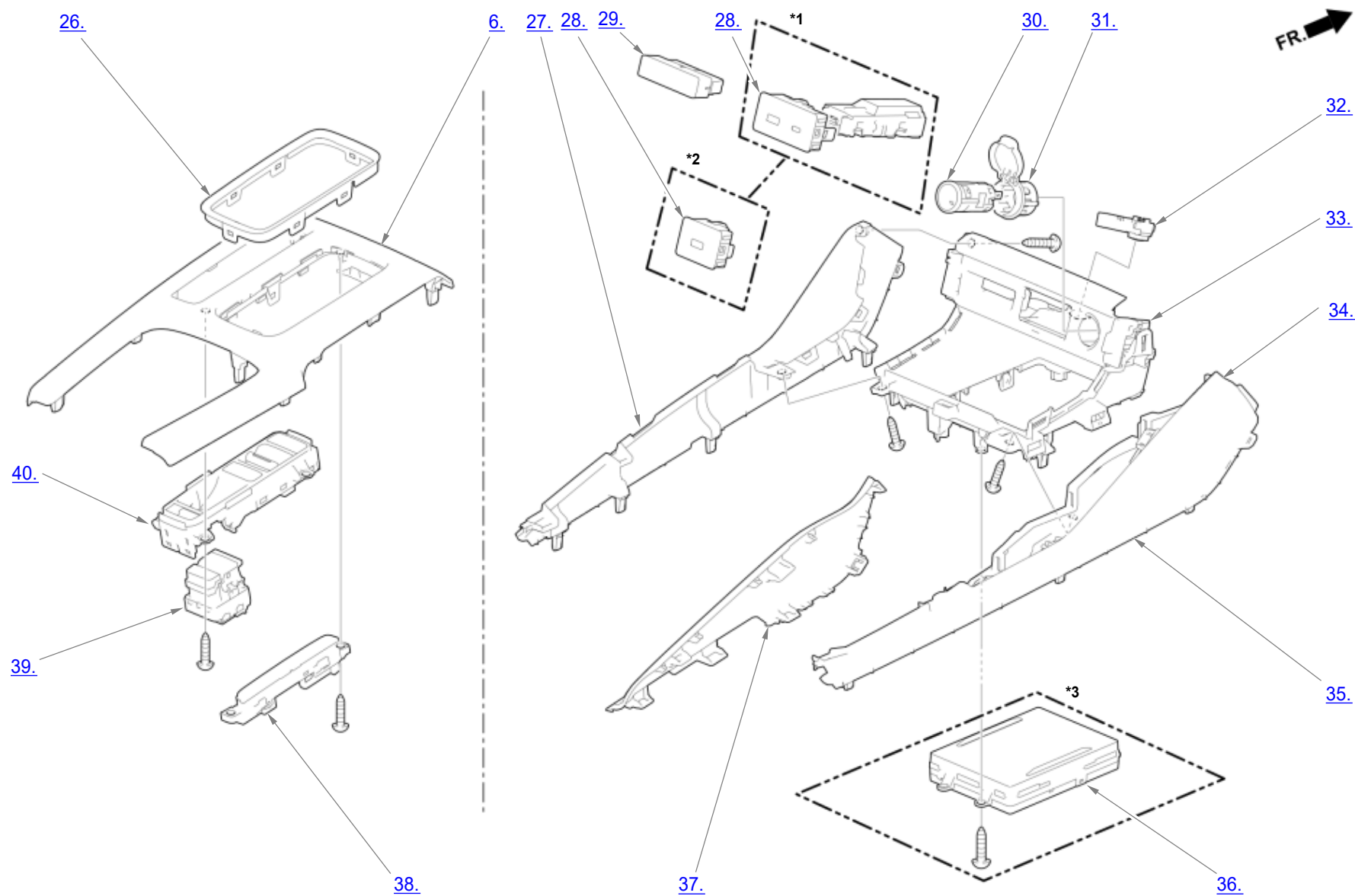

\*1: Display audio type (9 inch screen)

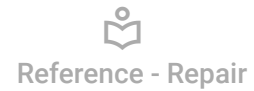

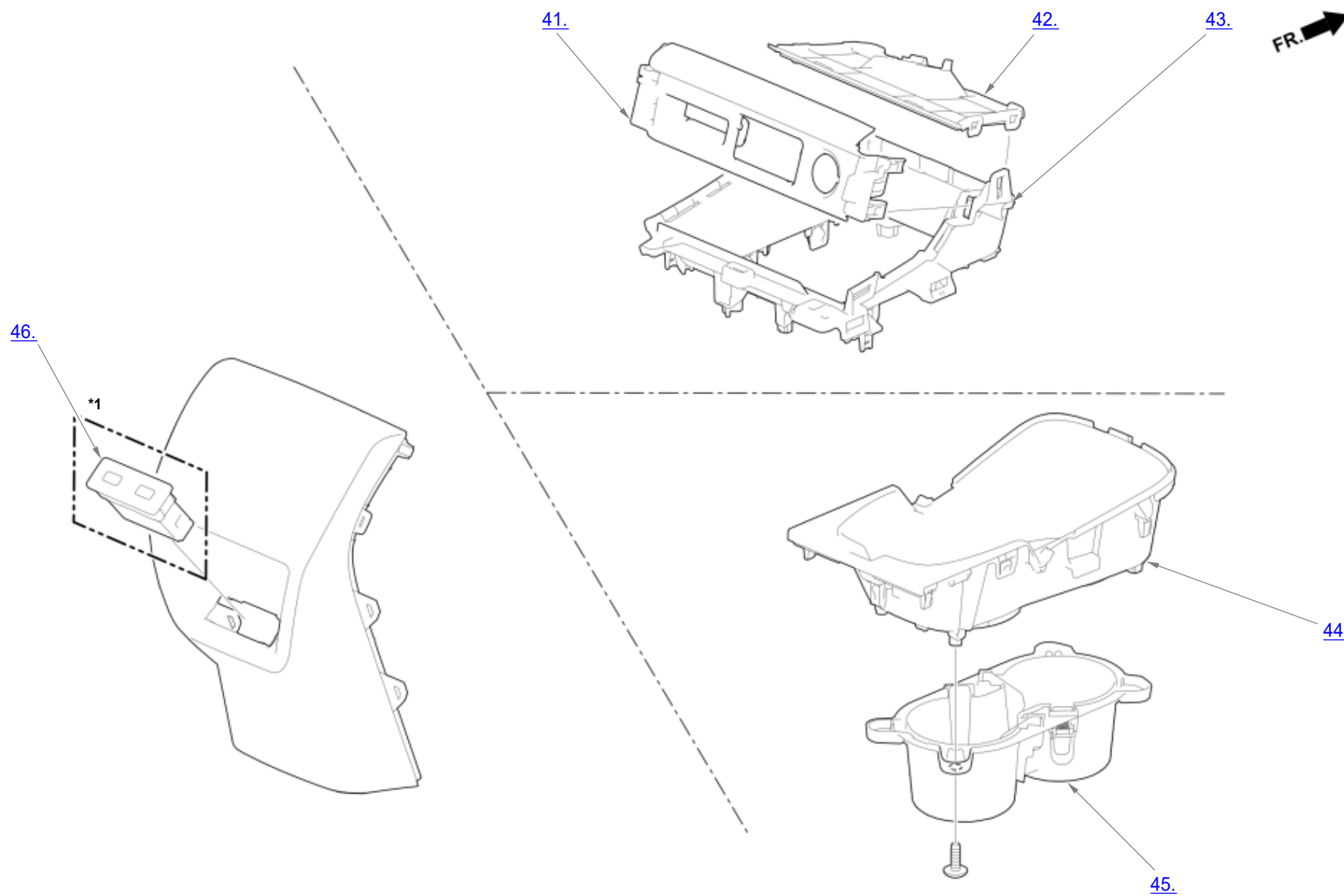

1. Center Console Box Mat

2. Cup Holder Assembly

3. Center Console Panel Assembly

4. Shift Lock Release Lid

5. Center Console

6. Center Console Panel

7. Shift Lever Boot

8. Shift Lever Knob

9. Shift Lever Knob Cover

10.Center Console Tray Mat

11.Center Console Tray Assembly

12.Front Interior LF Antenna

13.Rear Heater Joint Duct

14.Shift Cable (Select Lever Side)

15.Shift Lock Stop/Shift Lock Stop Cushion

16.Shift Lock Solenoid

17.Shift Lock Release

18.Shift Lever Bracket Base



Change

3

Bookmarks



Library



Convert



Reference - Repair

20.Center Console Armrest

21.Center Console Armrest Stopper

22.Rear Interior LF Antenna

23.Center Console Box

24.Driver's Center Console Side Panel

25.Passenger's Center Console Side Panel

26.Shift Lever Molding

27.Driver's Center Console Side Trim



Change

3

Bookmarks



Library



Convert



Reference - Repair

29.Front Passenger's Airbag Cut OFF Indicator

30.Center Console Accessory Power Socket

31.Housing

32.Center Console Light

33.Center Console Tray

34.Passenger's Lower Inner Garnish

35.Passenger's Center Console Side Trim

36.Wireless Charger

37.Passenger's Console Cover



Change

3

Bookmarks



Library



Convert



Reference - Repair

39.Electric Parking Brake Switch/Automatic Brake Hold Switch

40.Drive Mode Switch/Idle Stop OFF Switch/ECON Switch

41.Jack Panel

42.Center Console Upper Tray

43.Center Console Lower Tray

44.Cup Holder Trim

45.Cup Holder

46.USB Charger Unit (Rear Console)



Change

3

Bookmarks



Library



Convert



Reference - Repair